



## Description

The SV-100SF-PI, see Figure 1, is a 24VAC, Class 2 plug-in transformer that is used with a *Sivoia* or *Sivoia QED* motorized window shade. The transformer provides enough power for one *Sivoia* or *Sivoia QED* Motor Drive Unit to operate a 100 square foot shade (225 square foot for a high torque Motor Drive Unit). The transformer is designed to be plugged into a standard 120VAC receptacle. The transformer contains a circuit breaker on the secondary side to protect the device in the event of a miswire.

-  **Caution** - All wiring must be in accordance with national and local electrical codes.
-  **Caution** - Do not short the output AC terminals.
-  **Caution** - Ensure that the earth ground is connected to the *Sivoia* or *Sivoia QED* Motor Drive Unit.

## Installation

**Note:** Each transformer can power only **one** *Sivoia* or *Sivoia QED* Motor Drive Unit.

- 1. Run Motor Drive Unit power wiring to the transformer.** Run the low-voltage power and earth ground wiring from the Motor Drive Unit to the screw terminals on the secondary side of the transformer. See Figure 2.
- 2. Check that the output AC terminals are not shorted.**
- 3. Plug the transformer into a 120VAC receptacle.**  
**Note:** If the Motor Drive Unit does not power up after plugging in the transformer, press the circuit breaker reset button located on the transformer.

## Power Wiring Types and Maximum Lengths

Type	Maximum Length
3 conductor #16 AWG	200 ft.
3 conductor #18 AWG	150 ft.
3 conductor #20 AWG	100 ft.
3 conductor #22 AWG	60 ft.

Figure 1

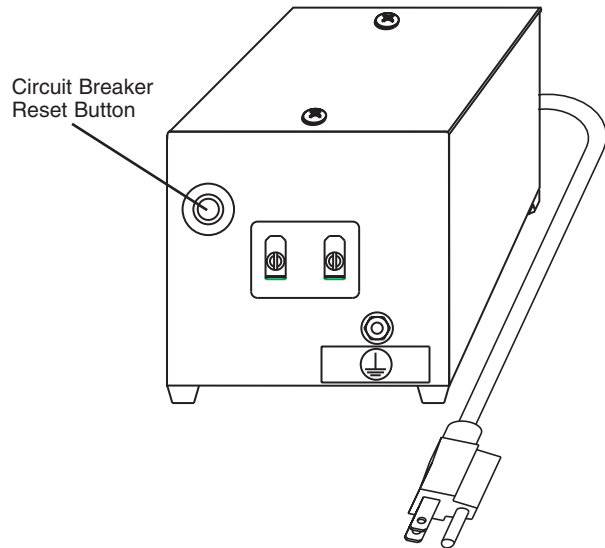

**Figure 2**

